

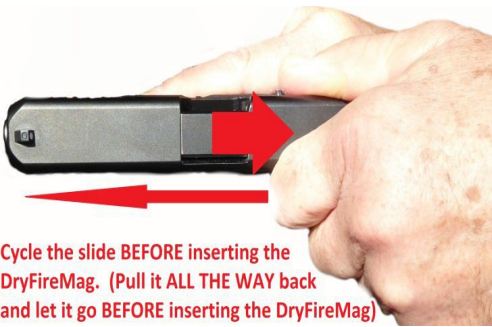

DryFireMag® for Glock® "double-stacks" Instructions

WARNING! Be sure that your firearm is not loaded before proceeding. A bullet can still be in the chamber even though no mag is in the gun.

THIS DEVICE IS SIMPLE TO USE, BUT IT MUST BE INSTALLED PROPERLY.



Cycle the slide BEFORE inserting the DryFireMag. (Pull it ALL THE WAY back and let it go BEFORE inserting the DryFireMag)



1. The slide must be "cycled" before inserting this DryFireMag!

2. Orient the mag under the mag-well as shown above.

3. Give the mag a bump with palm of your hand.

4. Grasp the bottom of the mag and give it a tug to ensure that it is "locked in".
5. Aim in a safe direction and begin dryfire practice.

*Once the **DryFireMag®** is in position, the first trigger pull will be extra heavy because you will be releasing the pistol's firing pin and activating the **DryFireMag®** mechanism. After the first pull, the **DryFireMag®** will be engaged and will provide a total dry fire practice experience.

There are a few slight adjustments that can be made by the user. If you desire a different pull, go to www.DryFireMag.com and watch the demonstration. If you need further assistance, or have questions, please contact us through the "contact" page on our website.



Be sure to register your DryFireMag® @
www.dryfiremag.com/dryfiremag-product-registration/

PLEASE NOTE: Since there are multiple modifications that can be made to different pistols, your **DryFireMag®** may not function as you have seen it work in the videos. This is probably *not* due to a malfunction in the **DryFireMag®** but to the wide range of variations possible in firearms. Because of this, the **DryFireMag®** may require an adjustment to meet your unique application. If you have more than one pistol, this may even vary slightly from one pistol to another.



To change the feel of the trigger pull when using the DryFireMag® to either a heavier or lighter pull, the coil spring will need to be changed. Your **DryFireMag®** has been tested and adjusted to the standard trigger pull of **5.5 #**. An extra spring is included for a lighter trigger pull. A Spring Kit with springs of varying weights is available for use in the **DryFireMag® for Glock** at www.dryfiremag.com/products.

(Remember to always wear safety glasses when changing springs).

To remove the standard spring, insert the tip of a small flat-head screw-driver between the spring retaining knob and the first coil, compress the spring slightly, and pry upwards. To insert the replacement spring, place one end over the spring retaining knob on the lever, compress the spring slightly, and push the other end into the spring pocket just opposite.

Interchangeable
Coil Spring

Trigger-Break
Adjustment
Set Screw



Pictured is the DryFireMag for double-stack Glocks

Adjusting the amount of pre-travel (the point of the simulated release of the firing pin).

1. Locate the 3/32 Allen wrench and the top hole on the back of the magazine.
2. To shorten the trigger pre-travel, turn the set screw clockwise 1/8 of a turn. Reinsert the DryFireMag® and test. If pre-travel is still not short enough, repeat adjustment and retest. Turn this adjustment **a maximum of one complete turn unless specifically advised by DryFireMag®.**
3. To lengthen the trigger pre-travel, turn the set screw counter clockwise 1/8 of a turn. Reinsert the DryFireMag® and test. If an even longer pre-travel is desired, repeat adjustment and retest. Turn this adjustment **a maximum of one complete turn unless specifically advised by DryFireMag®.**

For personal assistance, email TechSupport@DryFireMag.com, or call **Toll Free** at (844) 844-4600.

NOTE: DryFireMag® strongly recommends maintaining a frequent lubrication schedule per OEM protocol regarding lubrication points and products, especially when dry-firing with the DryFireMag. Failure to do so may result in inconsistent, or poor trigger reset functionality, as well as immoderate wear in trigger assembly parts.

Customer satisfaction is our #1 goal!

Satisfaction Guaranteed: If you are not completely satisfied with your **DryFireMag®**, you may return it within **30 days** of having received it for a full refund. Upon request, **DryFireMag®, LLC** will send a return label. We cannot provide postage for customers outside of the USA and its territories. Your refund will be issued when the product is received in an unaltered and undamaged condition.

Warranty: **DryFireMag®** will repair or replace your **DryFireMag®** at our option within 1 year of purchase for any malfunction of the **DryFireMag®** due to workmanship or faulty materials. Any malfunction due to tampering or physical damage will not be covered by this warranty. This will be determined at the sole discretion of DryFireMag, LLC. This warranty covers the original purchase price of the **DryFireMag®**. Contact us through the DryFireMag.com "Contact" page and choose the link that applies.

Anyone using the **DryFireMag®** assumes full responsibility for its use. DryFireMag LLC. assumes no responsibility for any damage to property, or personal injury due to any use of this device.